

LICENSING ACT 2003

Premises Licence

Appendix 1

Schedule 12
Part A (Regulation 33,34)
HARROW COUNCIL, P O BOX 18, STATION ROAD, HARROW

Premises Licence Number: LN/000003641/2017/4

Part 1 – Premises details

Postal address of premises, or if none, ordnance survey map reference or description:

Club KTM, 32 Railway Approach, Wealdstone, Harrow, Middlesex, HA3 5AA

Where the licence is time limited, the dates:

N/A

Licensable activities authorised by the licence:

Live music (e) Recorded music (f) Performance of dances (g) Performance similar to e f g
Late night refreshment
Sale of retail alcohol

Signed by Richard LeBrun
Environmental Services Manager (Public Protection)

Licensable Area**Hours open to public**

Sunday	00:00 - 02:30	12:00 - 00:00
Monday	00:00 - 00:30	12:00 - 00:00
Tuesday	00:00 - 00:30	12:00 - 00:00
Wednesday	00:00 - 00:30	12:00 - 00:00
Thursday	00:00 - 00:30	12:00 - 00:00
Friday	00:00 - 00:30	12:00 - 00:00
Saturday	00:00 - 02:30	12:00 - 00:00

**On commencement of British Summer Time one hour should be added to the finish time.
From the end of the sale of alcohol on the 31st December until the start of the sales of alcohol on the following day**

The times the licence authorises the carrying out of licensable activities**Location: Licensable Area****Live music (e) Recorded music (f) Performance of dances (g) Performance similar to e f g**

Sunday	00:00 - 02:00	12:00 - 00:00
Monday	-	12:00 - 00:00
Tuesday	-	12:00 - 00:00
Wednesday	-	12:00 - 00:00
Thursday	-	12:00 - 00:00
Friday	-	12:00 - 00:00
Saturday	00:00 - 02:00	12:00 - 00:00

**On commencement of British Summer Time one hour should be added to the finish time.
From the end of the sale of alcohol on the 31st December until the start of the sales of alcohol on the following day**

Location: Licensable Area**Late night refreshment**

Sunday	00:00 - 02:00	23:00 - 00:00
Monday	-	23:00 - 00:00
Tuesday	-	23:00 - 00:00
Wednesday	-	23:00 - 00:00
Thursday	-	23:00 - 00:00
Friday	-	23:00 - 00:00
Saturday	00:00 - 02:00	23:00 - 00:00

**On commencement of British Summer Time one hour should be added to the finish time.
From the end of the sale of alcohol on the 31st December until the start of the sales of alcohol on the following day**

Location: Licensable Area**Sale of retail alcohol**

Sunday	00:00 - 02:00	12:00 - 00:00
Monday	-	12:00 - 00:00
Tuesday	-	12:00 - 00:00
Wednesday	-	12:00 - 00:00
Thursday	-	12:00 - 00:00
Friday	-	12:00 - 00:00
Saturday	00:00 - 02:00	12:00 - 00:00

**On commencement of British Summer Time one hour should be added to the finish time.
From the end of the sale of alcohol on the 31st December until the start of the sales of alcohol on the following day**

Where the licence authorises supplies of alcohol – whether these are on and/or off supplies
Sale by retail on premises

Part 2

Name, (registered) address, telephone number and email (where relevant of holder of premises licence):

Prakash Pradhan

Registered number of holder, for example company number, charity number (where applicable):

Name, address and telephone number of designated premises supervisor where the premises licence authorises for the supply of alcohol:

Prakash Pradhan

Personal licence number and issuing authority of personal licence held by designated premises supervisor – where the premises licence authorises for the supply of alcohol:

HILLINGDON - LBHIL2816

State whether access to the premises by children is restricted or prohibited: **N/A**

Annex 1 – Mandatory Conditions

Mandatory conditions where licence authorises supply of alcohol:

- 1 No supply of alcohol may be made under the premises licence -
 - a) at a time when there is no designated premises supervisor in respect of the premises licence, or
 - b) at a time when the designated premises supervisor does not hold a personal licence or his personal licence is suspended
2. Every supply or sale of alcohol made under the premises licence must be made or authorised by a person who holds a personal licence.

Mandatory condition where licence requires door supervision:

Where one or more individuals are required to be at the premises to carry out a security activity, such individual(s) must be licensed by the Security Industry Authority.

The Licensing Act 2003 (Mandatory Licensing Conditions) (Amendment) Order 2014

1. (1) The responsible person must ensure that staff on relevant premises do not carry out, arrange or participate in any irresponsible promotions in relation to the premises.
 - (2) In this paragraph, an irresponsible promotion means any one or more of the following activities, or substantially similar activities, carried on for the purpose of encouraging the sale or supply of alcohol for consumption on the premises—
 - (a) games or other activities which require or encourage, or are designed to require or encourage, individuals to—
 - (i) drink a quantity of alcohol within a time limit (other than to drink alcohol sold or supplied on the premises before the cessation of the period in which the responsible person is authorised to sell or supply alcohol), or
 - (ii) drink as much alcohol as possible (whether within a time limit or otherwise);
 - (b) provision of unlimited or unspecified quantities of alcohol free or for a fixed or discounted fee to the public or to a group defined by a particular characteristic in a manner which carries a significant risk of undermining a licensing objective;
 - (c) provision of free or discounted alcohol or any other thing as a prize to encourage or reward the purchase and consumption of alcohol over a period of 24 hours or less in a manner which carries a significant risk of undermining a licensing objective;
 - (d) selling or supplying alcohol in association with promotional posters or flyers on, or in the vicinity of, the premises which can reasonably be considered to condone, encourage or glamorise anti-social behaviour or to refer to the effects of drunkenness in any favourable manner;
 - (e) dispensing alcohol directly by one person into the mouth of another (other than where that other person

is unable to drink without assistance by reason of disability).

2. The responsible person must ensure that free potable water is provided on request to customers where it is reasonably available.
3. (1) The premises licence holder or club premises certificate holder must ensure that an age verification policy is adopted in respect of the premises in relation to the sale or supply of alcohol.
(2) The designated premises supervisor in relation to the premises licence must ensure that the supply of alcohol at the premises is carried on in accordance with the age verification policy.
(3) The policy must require individuals who appear to the responsible person to be under 18 years of age (or such older age as may be specified in the policy) to produce on request, before being served alcohol, identification bearing their photograph, date of birth and either—
 - (a) a holographic mark, or
 - (b) an ultraviolet feature.
4. The responsible person must ensure that—
 - (a) where any of the following alcoholic drinks is sold or supplied for consumption on the premises (other than alcoholic drinks sold or supplied having been made up in advance ready for sale or supply in a securely closed container) it is available to customers in the following measures—
 - (i) beer or cider: ½ pint;
 - (ii) gin, rum, vodka or whisky: 25 ml or 35 ml; and
 - (iii) still wine in a glass: 125 ml;
 - (b) these measures are displayed in a menu, price list or other printed material which is available to customers on the premises; and
 - (c) where a customer does not in relation to a sale of alcohol specify the quantity of alcohol to be sold, the customer is made aware that these measures are available.”

Mandatory Condition order 2014

1. A relevant person shall ensure that no alcohol is sold or supplied for consumption on or off the premises for a price which is less than the permitted price.
2. For the purposes of the condition set out in paragraph 1—
 - (a) “duty” is to be construed in accordance with the Alcoholic Liquor Duties Act 1979
 - (b) “permitted price” is the price found by applying the formula—
$$P = D + (D \times V)$$
where—
 - (i) P is the permitted price,
 - (ii) D is the rate of duty chargeable in relation to the alcohol as if the duty were charged on the date of the sale or supply of the alcohol, and
 - (iii) V is the rate of value added tax chargeable in relation to the alcohol as if the value added tax were charged on the date of the sale or supply of the alcohol;
 - (c) “relevant person” means, in relation to premises in respect of which there is in force a premises licence—
 - (i) the holder of the premises licence,
 - (ii) the designated premises supervisor (if any) in respect of such a licence, or
 - (iii) the personal licence holder who makes or authorises a supply of alcohol under such a licence;
 - (d) “relevant person” means, in relation to premises in respect of which there is in force a club premises certificate, any member or officer of the club present on the premises in a capacity which enables the member or officer to prevent the supply in question; and
 - (e) “valued added tax” means value added tax charged in accordance with the Value Added Tax Act 1994
3. Where the permitted price given by Paragraph (b) of paragraph 2 would (apart from this paragraph) not be a whole number of pennies, the price given by that sub-paragraph shall be taken to be the price actually given by that sub-paragraph rounded up to the nearest penny.
4. (1) Sub-paragraph (2) applies where the permitted price given by Paragraph (b) of paragraph 2 on a day (“the first day”) would be different from the permitted price on the next day (“the second day”) as a result of a change to the rate of duty or value added tax.
(2) The permitted price which would apply on the first day applies to sales or supplies of alcohol which take place before the expiry of the period of 14 days beginning on the second day.

Mandatory conditions where licence authorises exhibition of films:

(1) The admission of persons under the age of 18 years to exhibitions of films must be restricted in accordance with any recommendation made by the British Board of Film Classification, except where condition 2 applies.

(2) The admission of persons under the age of 18 years to exhibitions of films must be restricted in accordance with any recommendation made by the relevant licensing authority regarding the film in question

Annex 2 - Conditions consistent with the operating Schedule

1. Staff are trained as appropriate in respect of relevant licensing law, the implementation of licence conditions, health safety, first aid, alcohol and drug awareness and conflict management.
2. Customers will not be permitted to take open glass containers outside the premises, as defined in the plan submitted with the operating schedule and approved by the Licensing Authority.
3. The consumption of alcohol will be restricted to those parts of the premises identified on the plan submitted with the operating schedule and approved by the Licensing Authority.
4. Notices will be displayed at each public entrance to the premises, which clearly state the premises policy on admission and searching.
5. Substantial food to be available until 23:30 hours.
6. The applicant monitors the need for door supervisors and in so doing takes into account any advice given by the Police.
 - i. SIA Door Supervisors shall be employed on any evening when the premises are open past midnight.
 - II. A "Magic Wand" metal detector shall be kept, maintained and used on the premises.
 - III. A register containing the full details of the Door Supervisors shall be kept on the premises and supplied to the Police or Local Authority on request.
7. The Metropolitan Police Service (MPS) must be given at least 14 days notice of all forthcoming events organized by an external promoter and have received a completed MPS Promotion / Event Risk Assessment (form 696) 14 days in advance of any such event. A copy of the form 696 is also to be provided to the Licensing Office at South Harrow Police Station.

The Metropolitan Police Service must have received a completed MPS Debrief Promotion / Event Risk Assessment (form 696a) three days after any risk assessed event.

8. The Pub Manager is required to actively participate in and support the local Pubwatch Scheme (where active)
9. In Line with our Alcohol and Social Responsibility Policy there will be no promotions that encourage illegal, irresponsible or immoderate consumption.
10. All incidents are logged and recorded in a log book.
11. There is an established procedure for the confiscation of drugs agreed with local police.
12. Known troublemakers are barred.
13. A security manual is available on site.
14. Toilets are checked an average of 2 hourly daily and a log kept of the times/dates they are visited.
15. The premises operate the current local authority or similar "proof of age" scheme and display the relevant literature.
16. CCTV shall be maintained and operated in good order and to the satisfaction of the Metropolitan Police Crime Prevention officer's reasonable request.
17. A monitored central station alarm and security system shall be maintained and operated in good order and to the satisfaction of the Metropolitan Police Crime Prevention Officer's reasonable request.
18. Free drinking water is available to customers.
19. Floor staff conduct physical sweeps inside the premises to remove hazardous objects/waste.
20. Phone number of an allocated taxi firm displayed on the premises.
21. The maximum number of persons accommodated on the premises at any one time should not exceed

280 (excluding staff)

22. Door supervisor and management monitor the behaviour of customers leaving the premises.
 23. Notices to be displayed to encourage customers to leave the premises quietly.
 24. Deliveries are conducted during daytime to control noise nuisance.
 25. Doors and windows shall be kept shut during the provision of licensable activities, except for purposes of access and egress.
 26. Noise or vibration shall not be permitted to emanate from the premises so as to cause a nuisance to nearby properties.
 27. Amplified sound equipment shall be governed by a sound limiting device set at a level approved by Environmental Health.
 28. No adult entrainment (paid for by the company of a nude nature) is permitted at these premises.
 29. All children under the age of 16 years are to be accompanied on the premises by a responsible adult.
 30. After 23:00 all performers shall be at least 18 years of age or over.
 31. Records of identity and address, passports and, where applicable, work permits of all performers performing after 23:00 shall be held by the licensee and produced to the licensing authority or the police upon request.
 32. No performance of mujra or similar kind will be offered.
 33. The performances shall not be advertised, or in any way publicised, as mujra.
 32. There shall be no physical contact between members of the audience and the performers.
 33. The licensee shall ensure that no money shall be paid by any member of the audience or other customer at the premises, to any performer(s), whether directly, or to the licensee or any member of staff, for the performers.
- Notices to this effect shall be placed throughout the premises.
34. Should any S.34 AWP machines be present on the premises, they must either be emptied nightly or fitted with an appropriate recommended security device
 35. A 'Challenge 21' scheme will be operated at the premises, whereby any person attempting to purchase alcohol or other age restricted product and who appears to be under the age of 21 years will be asked to provide proof (i.e. passport, driving licence or some other such accredited form of photo identification) that they are over 18 years of age: notices will be displayed advising that such a scheme is in operation; a record of age related refusals will be kept and made available to officers of the police and local authority upon request.
 36. No drinking vessels are permitted to be taken outside the premises.
 37. No entry or re-entry to the premises shall be permitted after 00:00 (midnight) from Sunday to Thursday, or after 00:30 on Fridays and Saturdays.

Annex 3 - Conditions attached after a hearing by the licensing authority

N/A

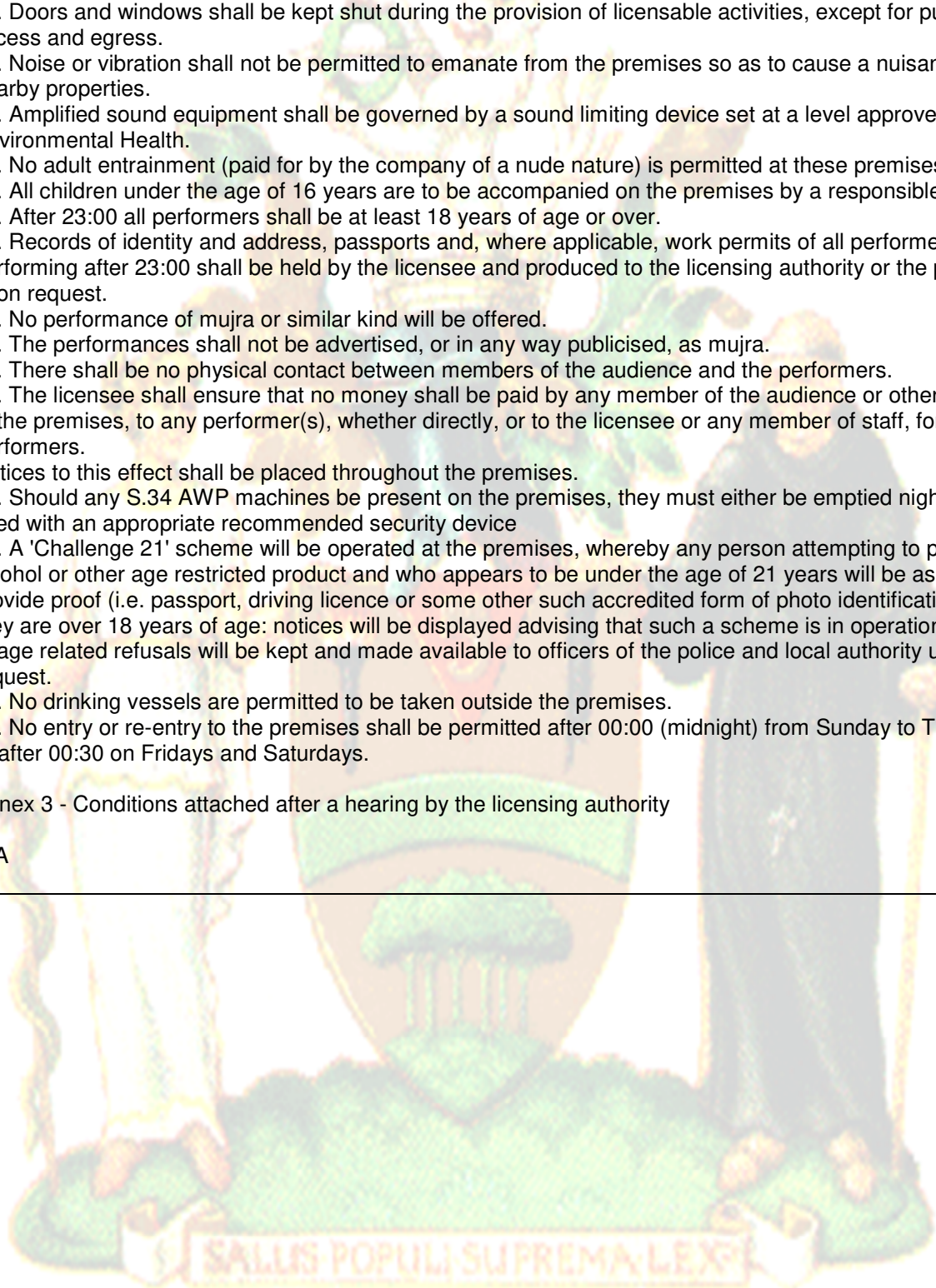

Annex 4 – Plan

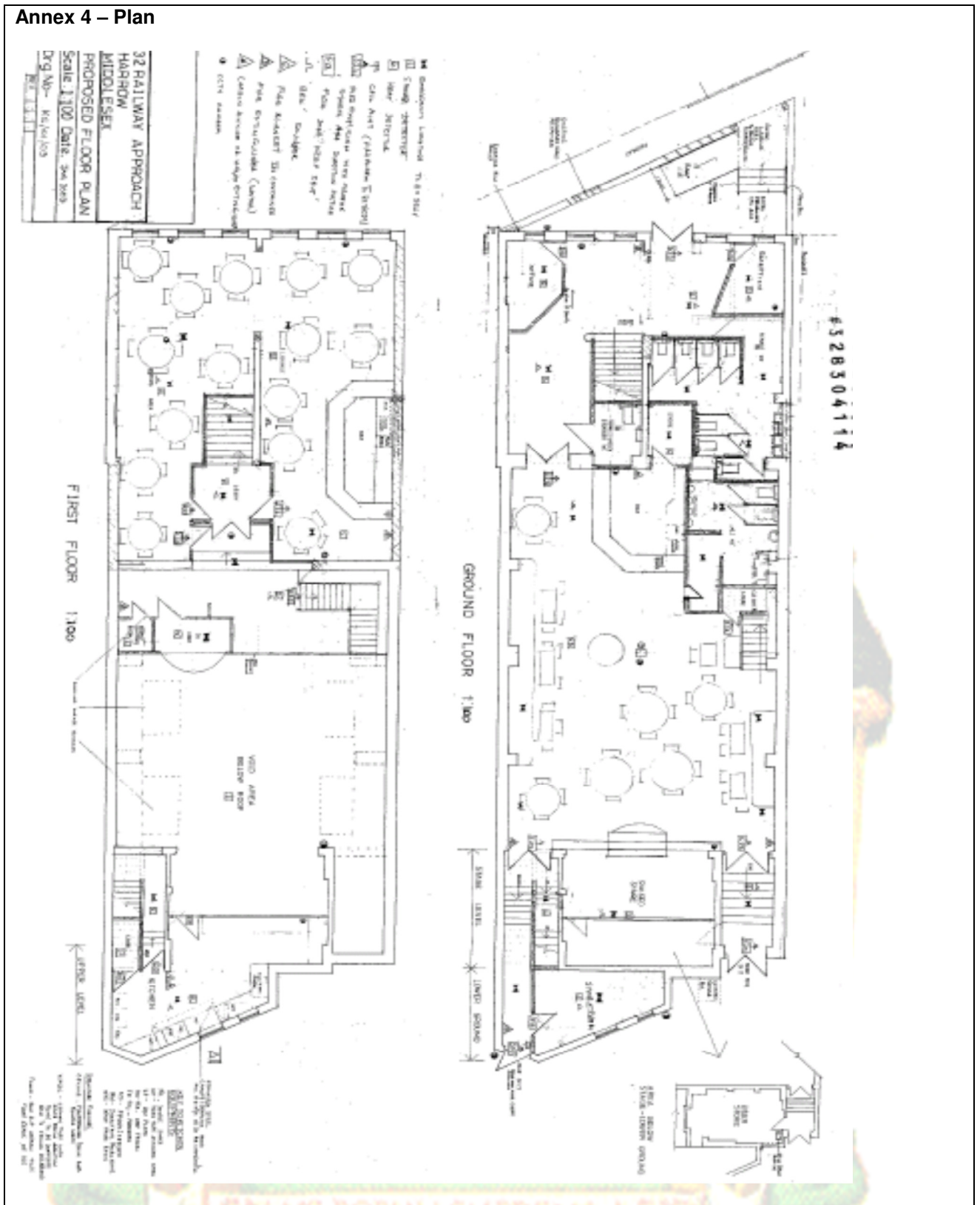

Date of original grant: 03/11/2010	Reason for issue: Variation Of DPS
Date of issue: 30th May 2017	Issue Number: 4